

## Switching on, setting up & connecting to Wi-Fi:

### Please Note:

If you are setting up your iPad in your Early Years establishment your iPad will automatically connect to the Glasgow Schools Network via the AppleEDU Wi-Fi network.

**1. Setup Instructions:** These are for those unable to access the videos & tutorials on Teachable.



#### Agenda / To do List:



- Your iPad
- Switch on iPad
- Connect to WiFi
- Passcode
- Apple ID
- Proxy Authentication
- Self Service to download & update apps
- Glow email using Outlook
- Troubleshooting & Helpdesk details
- Sign off to confirm completion of Deployment.

**2. You can insert the 2 tabs of the cover into the back of the case so that it stands up in portrait mode.**



**3. You can also find details in your Apple booklet, you collected, which shows the functions of the iPad buttons.**

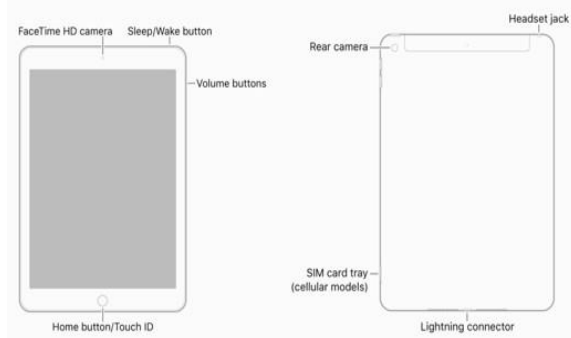

**4. Let's get started! Press & hold on the on/off button until the Apple icon shows. Then release to wake up your iPad.**



**5. Once awake, you will be at the Home Screen. Please select the Settings app to access your WiFi. YOU MUST be connected to a Network / internet before you can do anything else.**

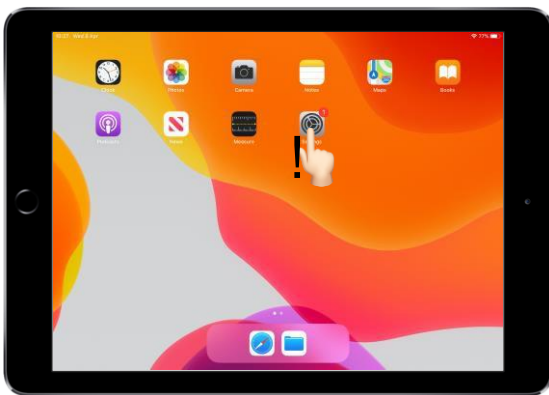

**6. In Settings, tap on WiFi – you will notice you are not yet connected to any Network. We need to do so, to activate the next steps.**

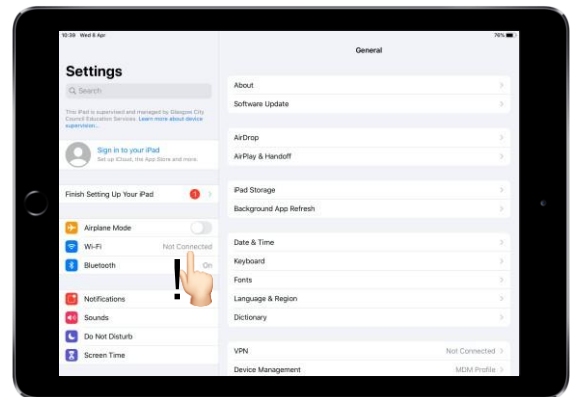

**7. Make sure your WiFi toggle is on / green and your iPad will search for the nearest Network.**

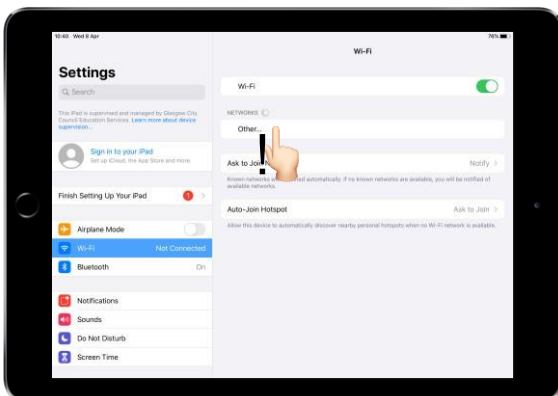

**8. Select the Network you want to use.**

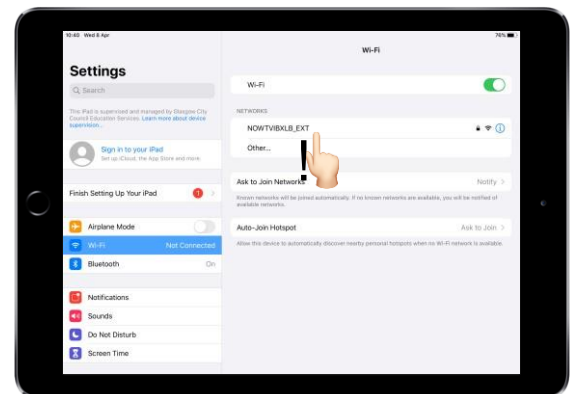

**9. Enter your WiFi password – this can be found on the back of your router.**



**10. Tap Join.**

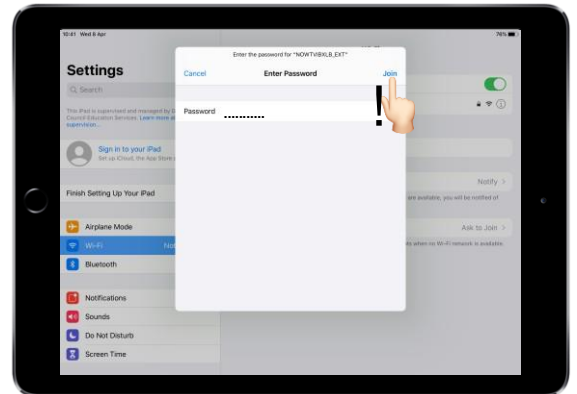

**11. WiFi setup complete once you see a tick ✓ Tap on Home Button.**

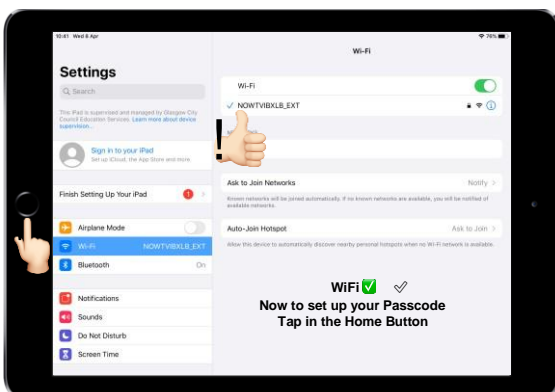

**WiFi Setup Complete but if you are still having issues with any of the above steps, please contact the Connected Learning Team.**