

Passcode Setup:

1. This notification **SHOULD** come up automatically from the Home Screen. If so, tap **Change Now**, and go to step 1a. If not – go to step 2.

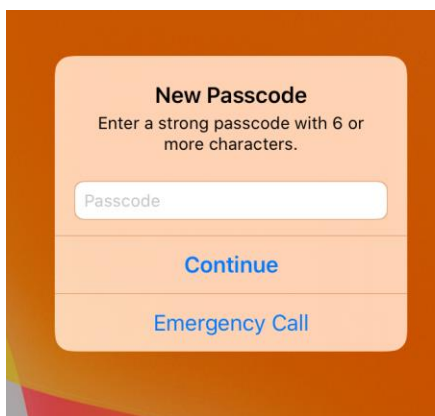

1a. Enter a Passcode: This is like a PIN to get into your iPad. Must be 6 digits BUT NOT ascending or descending. Now go to step 3.



2. IF NOT, tap Settings. Go to step 2a.

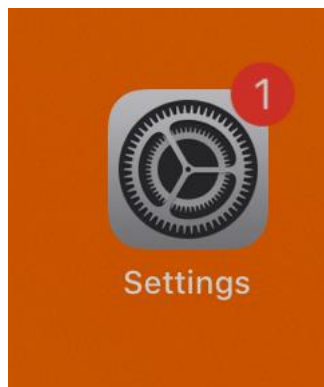

2a. Scroll down on the left-hand side menu & tap on Touch ID & Passcode. Go to step 2b.

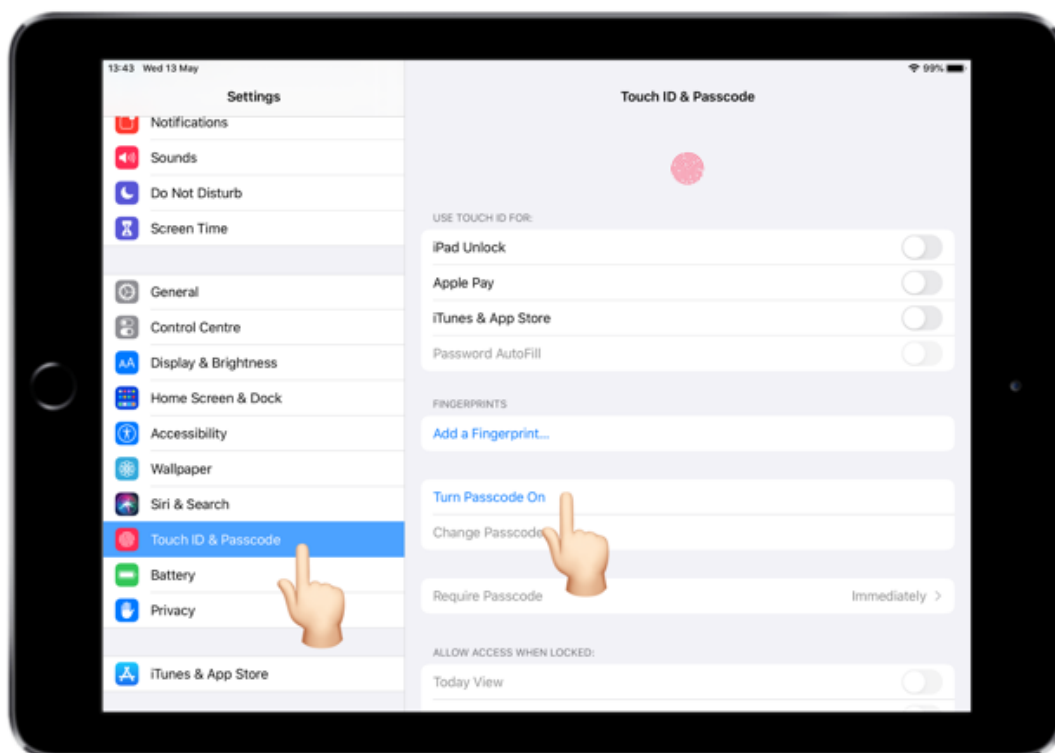

2b. Enter a Passcode. This is like a PIN to get into your iPad. Must be 6 digits BUT NOT ascending or descending. Go to step 3.

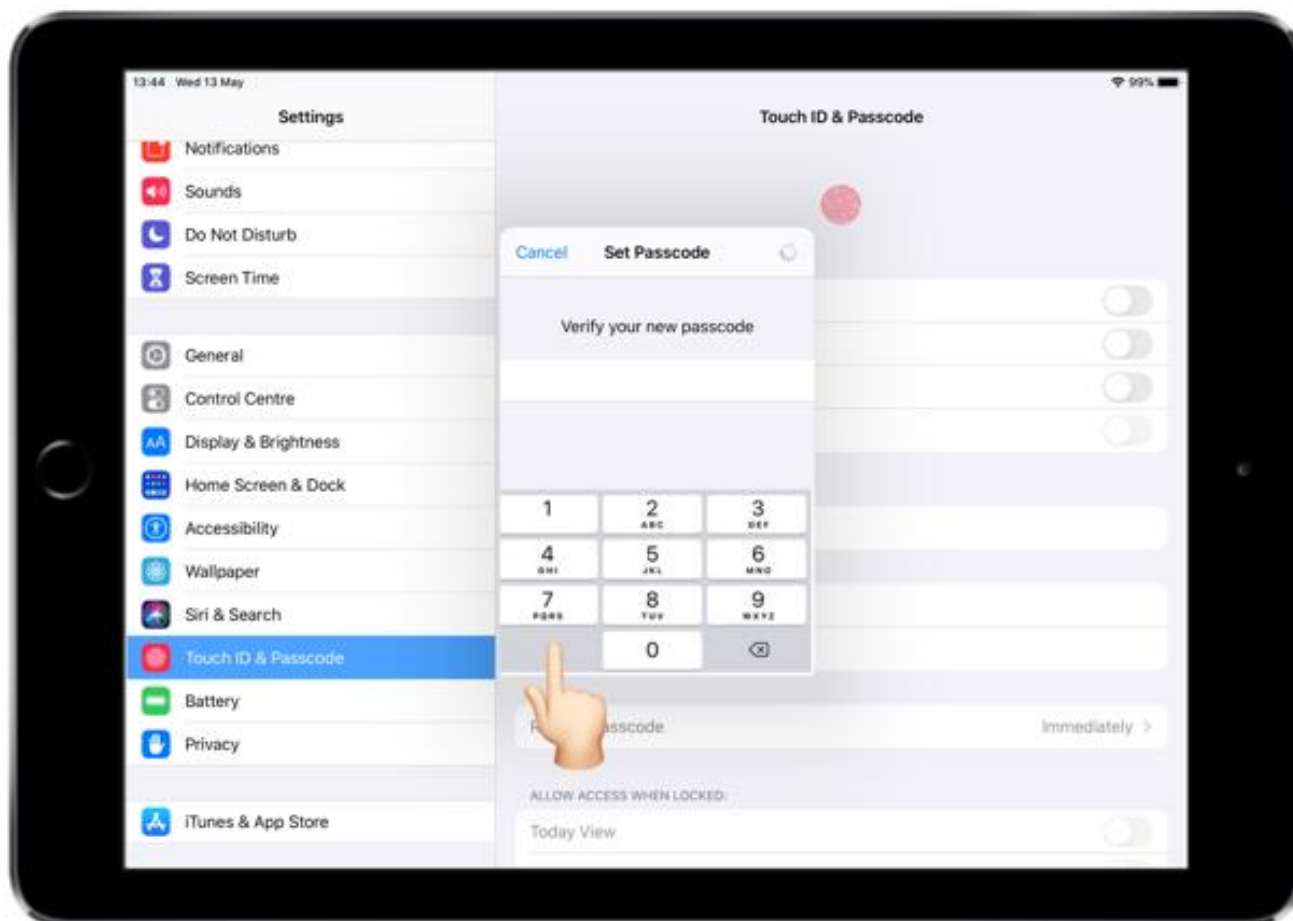

3. ONLY If the passcode is not secure e.g. 123456, you will be asked to re-enter a more secure option. Go to step 4.

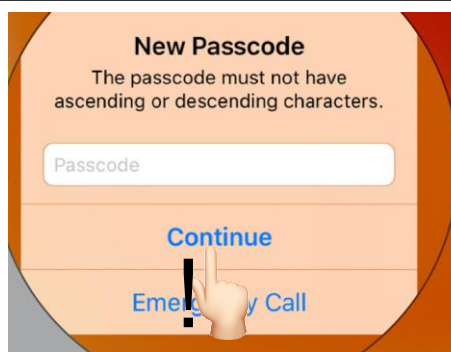

4. You will be asked to re-enter the passcode. This must match with the one you have previously entered.

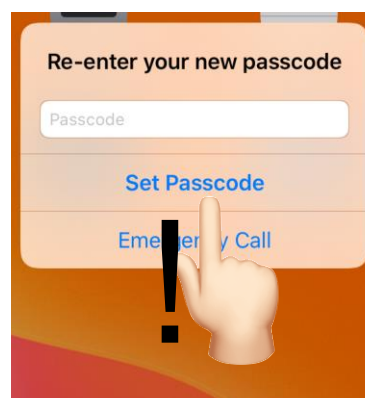

PASSCODE now set up.
Remember if you have issues with any of the above steps, please contact the Connected Learning Team. Contact details will have been emailed to you.