

OFFICIAL

GLASGOW CITY COUNCIL

EDUCATION SERVICES

**THIS IS A CONSULTATIVE
DOCUMENT**

Proposal: to relocate Cuthbertson Nursery class into the new nursery in the grounds of Cuthbertson Primary School along with Govanhill Nursery which will be open all year and provide early learning and childcare for children from age two to five years.

Schools	Ward(s)	Strategic Planning Area	Learning Communities
Govanhill Nursery	8	S	Holyrood
Cuthbertson Nursery Class	8	S	Shawlands
New nursery Cuthbertson	8	S	Shawlands

REPORT BY EXECUTIVE DIRECTOR OF EDUCATION

The Ordnance Survey map data included within this document is provided by Glasgow City Council under licence from Ordnance Survey in order to fulfil its public function in relation to this public consultation. Persons viewing this mapping should contact Ordnance Survey Copyright for advice where they wish to licence Ordnance Survey mapping/data for their own use.

OFFICIAL

OFFICIAL

1. Background and Context

- 1.1 In 2017, the Scottish Government published the '*Blueprint for 2020*', outlining proposals to deliver on the previously announced policy commitment to increase the statutory entitlement for early learning and childcare (ELC) from 600 to 1140 hours by August 2020. The *Blueprint* sets out requirements for local authorities to seek to deliver a service which prioritised quality, affordability, accessibility and flexibility.
- 1.2. In September 2017, Glasgow City Council submitted detailed plans to the Scottish Government, setting out proposals to deliver 1140 hours of statutory hours by August 2020. Our vision focusses on delivering the requirements set out in the *Blueprint*, with ELC settings moving to becoming all day, all year services, maximising choice and flexibility for parents and making better use of our resources and estate.
- 1.3. The Scottish Government confirmed on the 1st May 2018 that a capital award totalling £44.130m would be provided to undertake estate related projects in line with the expansion plans. The offer of £44.130m was predicated on being used for specific works associated with the expansion plans. It does not make financial provision for investment outwith the scope of funded eligibility i.e. 3 and 4 year olds and eligible two's.
- 1.4 Since the Scottish Government first announced the expansion programme, significant work has been undertaken to prepare information and develop Glasgow's response to the expansion plans across a wide range of workstreams, encompassing workforce, quality, communications, and partnership delivery. Property has been one of those key workstreams. Detailed analysis of ELC provision has been undertaken across the city, comparing demand (number of children and families) to supply (statutory places across all providers), to ensure that capital is allocated where most required. This exercise has identified specific communities across the city, requiring additional physical capacity to deliver the increase in statutory hours.
- 1.5 A paper on capital plans was taken to the City Administration Committee on 30th August 2018. In line with the recommendations from the paper, a non-statutory consultation took place during November 2018 to seek the views of stakeholders on a range of proposals to extend early learning and childcare across the city.
- 1.6 The above consultation advised of the proposal to locate a new nursery in the grounds of Cuthbertson Primary School.

2 Local Nurseries

- 2.1 Cuthbertson Nursery Class is open term-time from 8.30 am to 4.30 pm. It provides high quality early learning and childcare and has 40 full-time equivalent places for 3 to 5 year olds.

OFFICIAL

OFFICIAL

- 3.3 Govanhill Nursery is open all year from 8.00 am to 6.00 pm. It provides high quality early learning and childcare for 80 full-time equivalent places for 3 to 5 year olds.
- 3.4 The building at Govanhill Nursery is single storey of traditional construction with facing brick finish, flat roof and uPVC double glazing. Internally it has open plan style play rooms and toilets off the playrooms. Externally there is a tarmac play area with a small area of soft landscaping and a few mature trees. It would benefit from some modernisation and there is room on the site to create some modest extensions if required. It is registered presently for 80 3 to 5 year olds.
- 3.5 Appendix 1 shows the position of each of the nurseries.
- 3.6 Appendix 2 shows the design of the proposed nursery.

4 Proposal

- 4.1 It is proposed to relocate Cuthbertson Nursery Class into the new nursery being built on in the grounds of Cuthbertson Primary School. Govanhill Nursery is also being relocated into the new nursery. The new nursery would provide high quality early learning and childcare and would have 87 full-time equivalent places for 2 to 5 year olds.
- 4.2 The building at Govanhill Nursery School would be made available to other providers of early learning and childcare through the Council's flexible renting policy. The area which the nursery class currently uses will be given to the school. Adaptations will be made, as necessary. There will also be improvements made to the outdoor playing area of the primary school.
- 4.3 This is a significant increase in the number of places available and with extended hours which would give parents more flexibility.
- 4.3 A staffing structure would be put in place for the new nursery, which would take into account the requirements of the Care Inspectorate. The staff of Cuthbertson nursery class would be offered to relocate to the new nursery. All staff would continue to be employed by Education Services. Those staff who did not want to transfer to the new nursery would be offered suitable vacancies in other nurseries as available at that time. Discussions would take place with individuals and their trade unions to ensure that their individual needs and wishes are taken into consideration as much as possible. The staffing structure would include a mixture of staff on term-time and all year contracts.
- 4.4 The new nursery would be part of the Shawlands Learning Community.
- 4.5 From December 2020 until February 2021, Education Services carried out a consultation to seek views of stakeholders on a proposal to relocate Govanhill Nursery and Cuthbertson Primary School nursery class into the new nursery.
- 4.6 There were 32 responses to the consultation. Six of the respondents had a child in a Glasgow nursery. All of the six attended Cuthbertson nursery class.

OFFICIAL

OFFICIAL

- 4.7 26 respondents indicated their connection to Glasgow's nurseries. Of the 13 'other' responses, eight were teachers in Cuthbertson Primary School, one was a teacher in a school with a nursery and the others were from the local community.

What is your main connection to Glasgow's nurseries?			
Answer Choice		Response Percent	Response Total
1	A child in my family attends a Glasgow nursery	3.8%	1
2	I plan to send my child(ren) to a Glasgow nursery	11.5%	3
3	I work in a Glasgow nursery	0.0%	0
4	I live in a community served by a Glasgow nursery	30.8%	8
5	I have no links with Glasgow's nurseries	3.8%	1
6	Other (please specify):	50.0%	13
		answered	26
		skipped	6

- 4.8 80.6% (25) were in favour of the proposal with 21.9% (7) were against it.
- 4.9 21 respondents provided comments. Almost all of these comments wanted investment in the school playground.

'A new nursery will be excellent for the community but as Cuthbertson Primary will be losing part of their playground I feel that provision should also be made for: sheltered area for outdoor learning and poor weather, new storage as current storage sheds will be demolished, completely resurfaced playground – existing playground not fit for purpose, a multi-use games area where the existing nursery playground is located and works to make the old nursery rooms suitable for the school to use.'

There is planned investment in the play areas of Cuthbertson Primary School. It is intended that the resurfacing of the playground will commence over the summer break 2021. In addition, officers from PALS are engaging with the staff and Parent Council on what other improvements could be made to the playground to enhance outdoor learning and play opportunities for the children. There is a session planned with the school working group. This focused session with the school working group will help form and agree a best fit outdoor learning plan for Cuthbertson Primary and support the school with their aspirations. The objective remains to create improved green space and replace external storage lost after the demolition of the school shed, as well as exploring options to support outdoor learning, sport and play as part of the school's developing outdoor learning strategy.

OFFICIAL

OFFICIAL

‘As long as the capacity is more than increased otherwise the other nurseries should still operate and create further jobs for the community.’

One respondent felt that the proposal would mean fewer places. It should be noted that the Govanhill nursery building would be made available to a social enterprise/funded provider to continue to provide early learning and childcare. Therefore, there will be an increase in places.

Following the consultation in March 2021, the design team for the nursery held an event for members of the school community. At this event, stakeholders had the opportunity to contribute to ideas for improving the school grounds. These will be taken forward. Improvements to the playground are to take place over the summer break.

5. Roll Projection Methodology

5.1 Planning for the demand for nursery places is reviewed annually. Future demand is predicted taking into account the following factors:

- Birth rates in Glasgow.
- Housing needs assessment, contained in strategic and local plans.
- Migration of children in and out of Glasgow.
- The historical demand for placements made by parents resident in other Local Authorities.

5.2 Early Years’ establishments have fixed rolls and capacities agreed in partnership with the Care Inspectorate. Should the proposal be agreed, children who attend Govanhill Nursery and Cuthbertson nursery class would be offered a continued placement at the new nursery or an alternative nursery based on parental choice. The new nursery would have increased capacity to meet the anticipated demand for placements. In addition, it would offer new provision for younger children. Admissions would continue to be managed within the existing policy and procedures.

5.3 The consultation will include seeking ideas for a new name for the nursery. There will be a further consultation with parents of the new nursery to finalise the name.

6. Educational Benefit Statement For The Proposal

6.1 The Children

6.1.1 Currently, both nurseries provide high quality early years education and childcare. They provide valued support to parents and carers. The development of the new nursery will continue this high standard of provision. The new nursery would provide high quality playrooms. This would provide a quality learning environment and support children’s learning within Curriculum for Excellence at the early level. In addition, toilet and changing facilities

OFFICIAL

OFFICIAL

would be improved to a level that would exceed legislative requirements and meet the needs of all the children including those with additional support needs.

- 6.1.2 The new building would highlight the value that the Council places on the importance of a high quality-learning environment, particularly for our most vulnerable children. The nursery would include a dedicated parents' room to allow the nursery to provide family support in line with the Council's policy on early intervention.
- 6.1.3 The grounds around the nursery would be designed to provide high quality playground and outdoor space. This would provide better opportunities for children to play and learn. The appendices provide an indication of how the nursery will look with its grounds landscaped.

6.2 Parents, Carers and Local Community

- 6.2.1 The new nursery would increase the number of nursery places available for parents all year round. The new nursery would provide a focus for the community engagement and further develop existing community links.
- 6.2.2 It is proposed that the nursery would be open throughout the year from 8.00 am to 6.00 pm. This would offer families, particularly working parents, childcare and education throughout the year. This is in line with the national and Council priority to support working families and the economy.
- 6.2.3 The development of the nursery would extend access to services and nursery places available to vulnerable two year olds and their families.
- 6.2.4 The nursery would have facilities, which would allow parents to become involved in the life and work of the centre. A parents' room would be created and families encouraged to work with staff and other partners to better understand a range of issues such as child development, parenting, budgeting as well as offer opportunities for continued adult education. The development of parents' room and visiting professionals' accommodation in the new nursery would significantly improve opportunities for partnership work.
- 6.2.5 It is important that parents and carers are secure in the knowledge that their families and children's needs are understood and met. Education staff in the new nursery would build on the already existing good practice in both nurseries and work in collaboration with a wide range of professional partners.

6.3 Other users

- 6.3.1 The new nursery would have improved facilities. There are currently no other users of the two existing nurseries. The nature of the layout of nurseries make it generally unsuitable for other users to let in the evenings.

6.4 Future users of the provision

OFFICIAL

OFFICIAL

- 6.4.1 The changes proposed would improve the facilities in the area. There would be no detriment to future users of the provision.

6.5 Other schools/establishments in our authority

- 6.5.1 The proposal would not impact adversely on other schools or establishments. The new nursery would expand the number of early years' places available in the south of the city and would reduce demand for placement at other establishments in the area.

6.6 Our assessment of any other likely effects of the proposal (if implemented)

- 6.6.1 The proposal would increase the number of available early years' places in the south of the city. With two staff teams coming together there will be increased opportunities for sharing of good practice. A larger staff allows for further sharing of best practice and more opportunities for curriculum development.

6.7 How we would intend to minimise or avoid any adverse affects that may arise from the proposal (if implemented)

- 6.7.1 Education Services has a duty to secure improvement in education. Through our quality assurance and improvement policy, Education Services monitors and supports the quality of education being delivered in all its establishments. This policy would be used to monitor and support the quality of education and care being delivered in the new establishment to ensure that provision for children continues to develop and improve. Leaders of Early Learning, Quality Improvement Officers would provide support prior to, during and after the development of the new nursery to ensure continuity of learning.

6.8 The benefits, which we believe, would result from implementation of this proposal

- 6.8.1 In addition to the benefits detailed above, this proposal would support the desire that schools and communities have access to high quality resources.

7. Equality Statement

- 7.1 An Equality Impact assessment will be undertaken as part of the consultation exercise to assess if the proposal discriminates against anyone on the basis of:
- Age
 - Gender
 - Religion
 - Racial Group
 - Disability
 - Sexual Orientation

OFFICIAL

OFFICIAL

In carrying out the equality impact assessment we will take account of (and address) any equality issues raised in written or oral representation made as part of the consultation process. The result of the equality impact assessment will be included in the consultation response document and will also be available on the Glasgow City Council website.

8. Proposed Date For Implementation Of The Proposal

- 8.1 It is intended that, if agreed, the proposal would be progressed when the building is completed. The final date will depend on the progress of the building works.

9. The Consultation Process

- Parent Council
- Parents/carers/children
- Staff
- Trade Unions
- Community Councils
- Area Partnership
- Groups formed under Part 2 of the Local Government in Scotland Act (2003)
- Other neighbouring education authorities
- Other users of the school premises

Notices to advise of the consultation arrangements have been placed in the press and a dedicated page has been set up on the Council website for both information and to enable interested parties to respond to the proposals.

Web site address: www.glasgow.gov.uk/schoolconsultations

E-mail address: Schoolconsultations@glasgow.gov.uk

Consultation responses will be gathered via a Survey Monkey questionnaire which will be on the web-site and placed in press adverts. Schools and nurseries will also be asked to include the link in their newsletters to parents and carers. In addition, full use will be made of social media to ensure as wide a reach as possible to stakeholders.

The link is: <https://www.smartsurvey.co.uk/s/CNConsult/>

Stakeholders who do not have access to IT can use local libraries/community cafes. Schools will also be encouraged to support parents as they did successfully when on-line school registration was introduced.

OFFICIAL

OFFICIAL

10. Timetable

10.1 The indicative timetable for the consultation is:

Date	Action	Location
30 August 2021	Start of Public Consultation Period	
Wed 8 September 2021	Public meeting 7pm	Cuthbertson Primary School
20 October 2021	End of Public Consultation Period	
27 October 2021	Education Scotland involvement	
To be confirmed	Consultation response report published at least 3 weeks prior to City Administration Committee	
To be confirmed	Report to City Administration Committee	

10.2 Arrangements have been put in place to ensure the inclusiveness of the process e.g. a plain English/easy-read version of the document has been produced.

10.3 As stated above a public meeting will be held to discuss the proposal. Anyone wishing to attend the public meeting is welcome to do so. The meeting will be an opportunity for attendees to:

- Hear more about the proposal.
- Ask questions about the proposal.
- Have their views noted so that they can be taken into account as part of the consultation response process.
- Ask officers about the various ways in which they can respond to the proposal.

10.4 The public meeting will take into consideration the health and safety guidance in place for COVID-19 at that time. Participants will require to sign in, sanitiser will be provided and the appropriate physical distancing arrangements, face coverings will be recommended to be worn unless participants are exempt.

11. Involvement of Education Scotland (HMI)

11.1 This consultation is within the Schools (Consultation) (Scotland) Act. Education Scotland will be informed of the consultation through the Area Lead Officer.

OFFICIAL

OFFICIAL

- 11.2 A copy of the consultation proposal will be sent to Education Scotland by Education Services. They will also receive a copy of any written representations that are received by Education Services from any person during the consultation period or, if Education Scotland agree, a summary of them. They will also receive a summary of any oral representation made to Education Services at the public meeting and a copy of any other relevant documentation.
- 11.3 Education Scotland will then prepare a report on the educational aspects of the proposals no later than three weeks after Education Services has sent them all representations and documents as mentioned above.
- 11.4 In preparing their report, they may visit the affected establishments and make such reasonable enquiries of such people there, as they consider appropriate, and may make such reasonable enquiries of such other people as they consider appropriate.

12. Preparation of Consultation Response Report

- 12.1 Education Services will review the proposals having regard to the Education Scotland report, responses to the consultation and oral representations made at the public meeting. Education Services will then prepare a consultation response report for consideration by the Council's City Administration Committee.
- 12.2 This consultation response report will be published in electronic and printed formats and will be available on the Glasgow City Council website, Education Services, City Chambers East Building, 40 John Street, Glasgow G1 1JL and at the affected schools free of charge. All those who received direct notification of the consultation will be sent either a full or summary response document. All those who responded and provided contact details through the consultation process will also receive a copy of the full or summary response document as appropriate.
- 12.3 The response report will include a record of the total number of written representations made during the consultation period, a summary of the oral representations made at the public meeting(s), the council's response to the Education Scotland report and any other relevant information, including details of any alleged inaccuracies and how these have been handled. The report will also contain a statement explaining how it complied with the requirements to review the proposal in light of the Education Scotland report and representations (both oral and written) that is received. The Consultation Response Report will be published at least three weeks prior to the City Administration Committee making a decision.
- 12.4 Reasonable requests for alternative forms of consultation papers or response documents will be accommodated wherever possible e.g. audio or by interpreted support. Should you wish a copy of this consultation paper or response documents in any other format please contact Education Services:

OFFICIAL

OFFICIAL

- Online at schoolconsultations@glasgow.gov.uk
- At Education Services, City Chambers East Building, 40 John Street, Glasgow G1 1JL
- Or by calling 0141 287 4327

12. Note on Corrections

- 12.1 If any inaccuracy or omission is discovered in this proposal document and/or during the consultation either by Education Services or any person, Education Services will determine if relevant information has been omitted or, if there has been an inaccuracy. Education Services will then take appropriate action, which may include the issue of a correction or the reissuing of the proposal document or the revision of the timescale for the consultation period as appropriate. In that event, relevant consultees and Education Scotland will be advised.

13. Conclusions from the Consultation Exercise

- 13.1 The conclusions and outcomes of the Consultation exercise will be presented to the Council's City Administration Committee.

14. Scottish Ministers' Call-In

- 14.1 The Schools (Consultation) (Scotland) Act 2010; If the proposal is approved (that is to close schools and re-build on a new site) there is a three week period, which begins on the date the decision is made, for anyone to make representations to Scottish Ministers requesting the case to be called in. There is then a further three-week period for Ministers to reach a decision on whether or not to call in the case. Once a decision has been reached, the local authority in question and each individual who had requested a call in will be notified of the decision.

OFFICIAL

Appendix 1

Cuthbertson Primary School & Nursery Class

Govanhill Nursery School

&

Proposed Site of New Nursery School

 Cuthbertson Primary School & Nursery Class

 Govanhill Nursery School

 Proposed New Nursery School Site

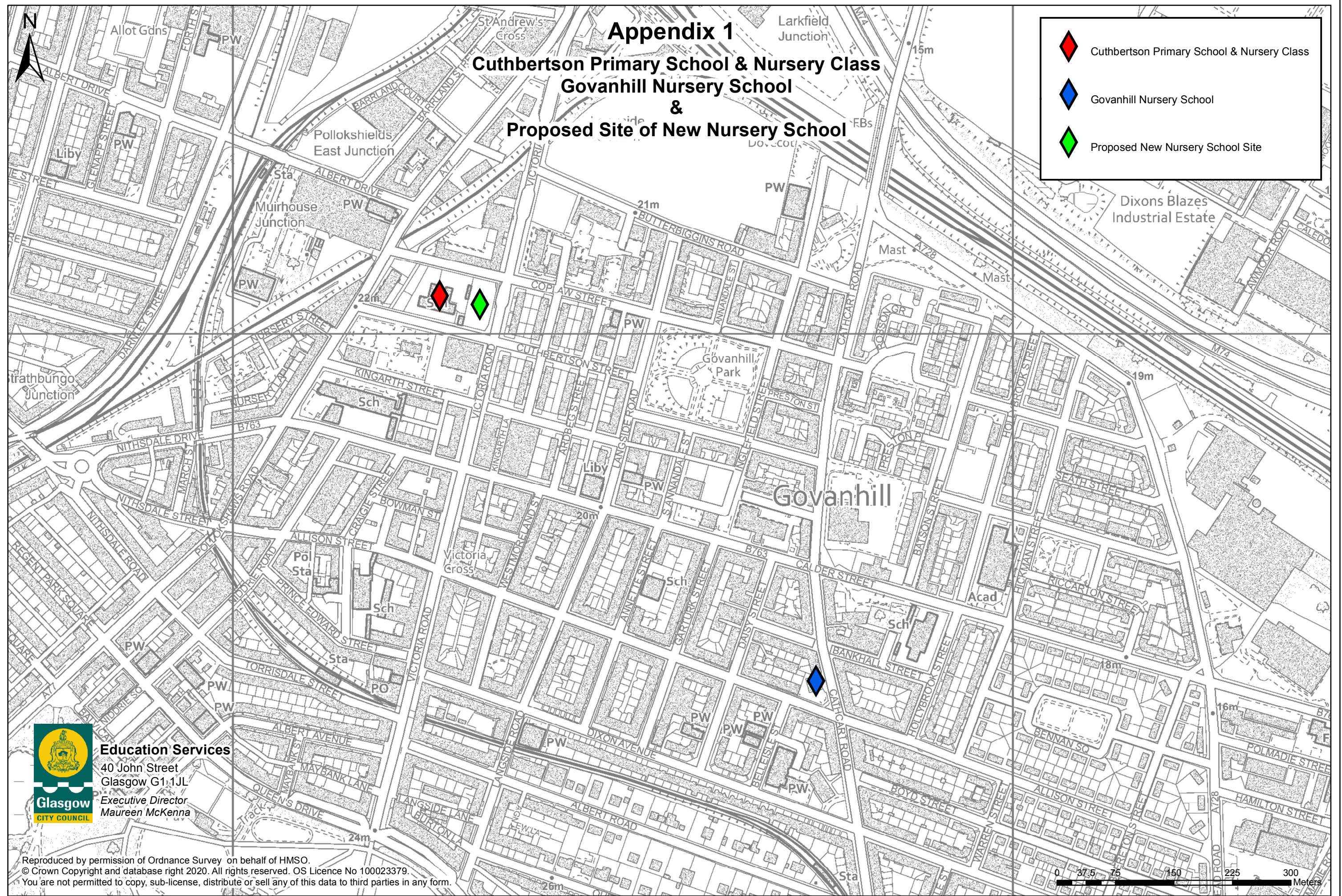

Education Services
 40 John Street
 Glasgow G1 1JL
 Executive Director
 Maureen McKenna

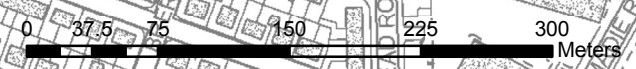

REV	DESCRIPTION	DATE	BY

Appendix 2



DRAWING STATUS
PLANNING



Glasgow City Council
Development & Regeneration Services
Project Management & Design
231 George Street, Glasgow, G1 1RX
www.glasgow.gov.uk
Tel: 0141 287 8555 Fax: 0141 287 8444
Executive Director: Richard Brown

JOB
**NEW EARLY LEARNING &
CHILDCARE FACILITY AT
GOVANHILL**

TITLE
**3D Visualisation
View from the External Playspace**

SCALE at A3 NTS	DATE 2020/01/09	DRAWN GP
JOB NO. ED416001	APPROVED JL	
DRG NO. A-VS(01)XX-002-PL	REVISION -	

CAD FILE: ...ED416001-A-VS(01)XX-002-PL_3D Visualisation.dgn
PLOTTED BY: ON 31/01/2020 AT 13:36:40

DO NOT SCALE: WORK TO FIGURED DIMENSIONS ONLY
DRS_A3_TTT - MM March 2009

REV	DESCRIPTION	DATE	BY

Appendix 2a



DRAWING STATUS

PLANNING



Glasgow
CITY COUNCIL

Glasgow City Council
Development & Regeneration Services
Project Management & Design
231 George Street, Glasgow, G1 1RX
www.glasgow.gov.uk
Tel: 0141 287 8555 Fax: 0141 287 8444
Executive Director: Richard Brown

JOB
**NEW EARLY LEARNING &
CHILDCARE FACILITY AT
GOVANHILL**

TITLE
**3D Visualisation
View towards the main entrance
from Victoria Road**

SCALE at A3 NTS	DATE 2020/01/09	DRAWN GP
JOB NO. ED416001	APPROVED JL	
DRG NO. A-VS(01)XX-001-PL	REVISION -	

CAD FILE: ...ED416001-A-VS(01)XX-001-PL_3D Visualisation.dgn
PLOTTED BY \$ ON 31/01/2020 AT 19:00:29

DO NOT SCALE: WORK TO FIGURED DIMENSIONS ONLY
DRS_A3_TTT - MM March 2009

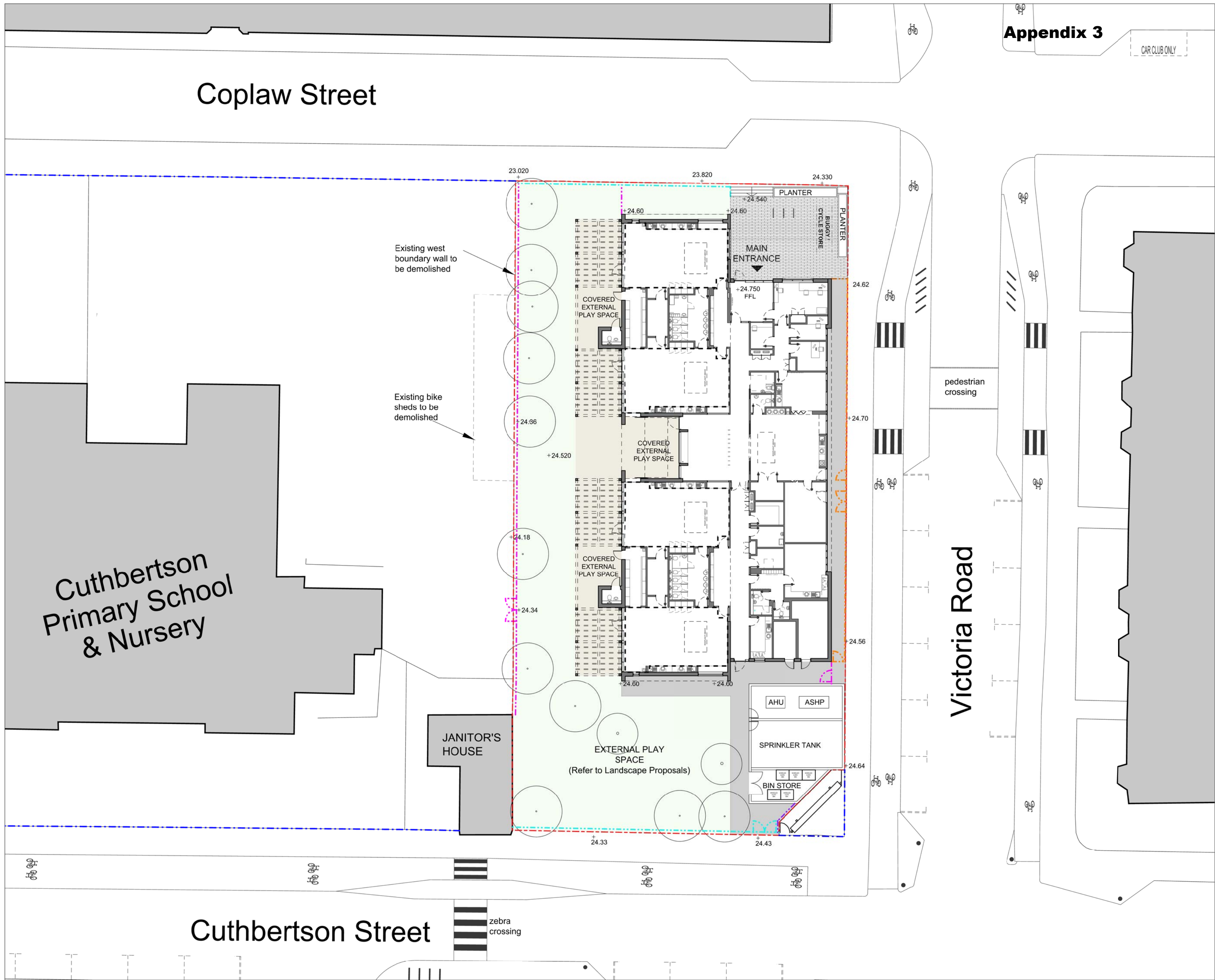

SITE PLAN AS PROPOSED
SCALE - 1:250



Appendix 3

CAR CLUB ONLY

- NEW TREES
- PAVING
- BITMAC SURFACE
- SOFT LANDSCAPING, REFER TO LANDSCAPE PROPOSALS
- COVERED/ SEMI COVERED EXTERNAL PLAY SPACE - HARD LANDSCAPING
- 1.8M HIGH WELDMESH FENCE ABOVE EDGING/ KERB, COLOUR GALVANISED, COLOUR TBC
- 1.3M HIGH METAL RAILING FENCE WITH DECORATIVE LASER CUT METAL INFILL PANELS & GATES (COLOUR GALVANISED, COLOUR TBC)
- 1.8M HIGH METAL RAILING FENCE & GATES (COLOUR GALVANISED, COLOUR TBC) ON TOP OF APPROX. 450mm HIGH BRICK BASE WITH BRICK PIERS AND PRECAST CONCRETE COPIES
- 1.8M HIGH METAL RAILING FENCE & GATES (COLOUR GALVANISED, COLOUR TBC)

NB: Cycle lanes & alterations to the carriageway & footways along Cuthbertson Street & Victoria Road as shown, is currently under construction by others as part of GCC's South City Way.

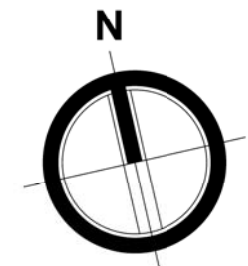

- SITE BOUNDARY LINE
- ADJACENT LAND IN GCC OWNERSHIP

USE FIGURED DIMENSIONS ONLY. DO NOT SCALE FROM THIS DRAWING. ALL DIMENSIONS IN MM UNLESS NOTED OTHERWISE.
ALL DIMENSIONS TO BE VERIFIED ON SITE BEFORE PROCEEDING WITH WORK.
GCC DRB PROJECT MANAGEMENT AND DESIGN (PM&D) TO BE NOTIFIED IN WRITING OF ANY DISCREPANCIES PRIOR TO ORDERING MATERIALS OR COMMENCING WORK.
TO BE READ IN CONJUNCTION WITH ALL OTHER PM&D DRAWINGS, SCHEDULES AND SPECIFICATIONS.
ALL DRAWINGS TO BE READ IN CONJUNCTION WITH ENGINEER'S DRAWINGS.
REFER TO CONSULTANTS' DRAWINGS FOR STRUCTURAL AND SERVICES INFORMATION.

DRAWING STATUS

PLANNING



Glasgow City Council
Development & Regeneration Services
Project Management & Design
231 George Street, Glasgow, G1 1RX
www.glasgow.gov.uk
Tel : 0141 287 8555 Fax : 0141 287 8444
Executive Director : Richard Brown

JOB
NEW EARLY LEARNING & CHILDCARE FACILITY AT GOVANHILL

TITLE
Site Plan as Proposed

SCALE at A2 1:250	DATE 2019/11/08	DRAWN YP
JOB NO. ED416001	APPROVED JL	
DRG NO. A-DR(01)ST-100-PL	REVISION	

CAD FILE ...ED416001-A-DR(01)ST-100-PL Site Plan as Proposed
PLOTTED BY ON 31/01/2020 AT 12:22:23

DO NOT SCALE : WORK TO FIGURED DIMENSIONS ONLY