

The CHILDREN'S WOOD EDUCATION PACK

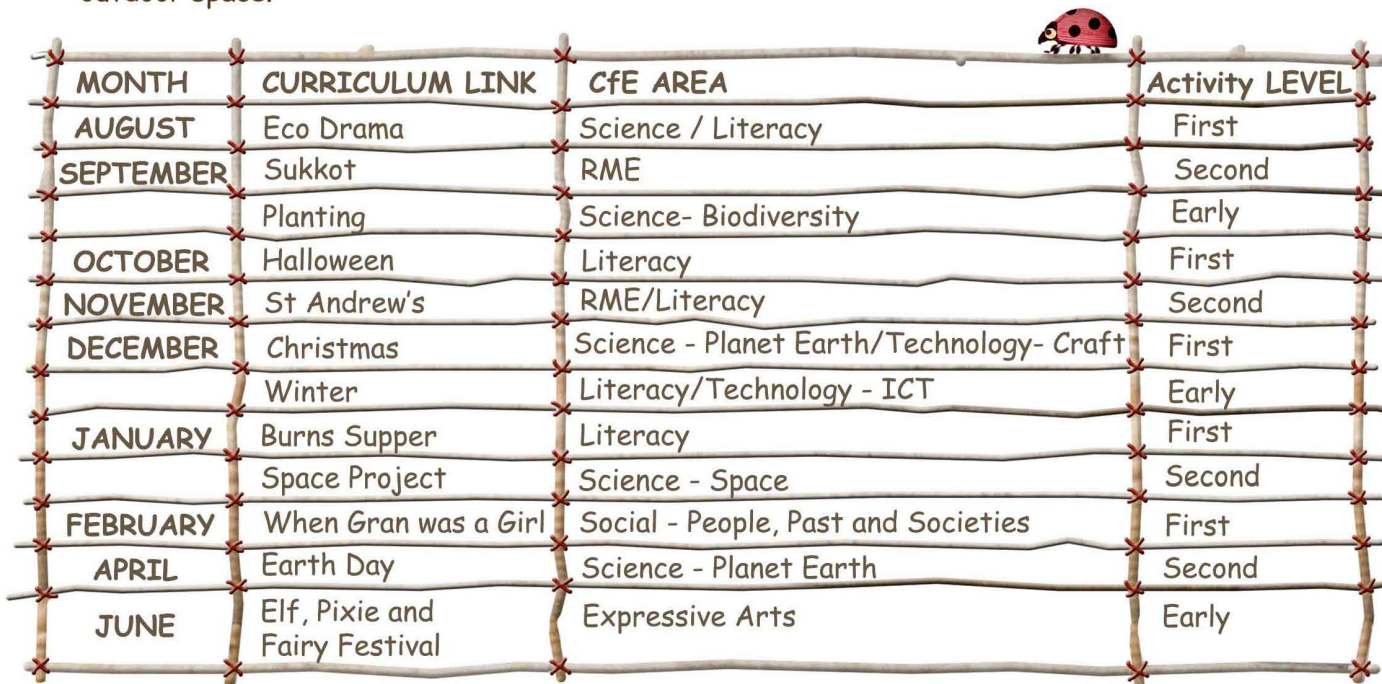

The CHILDREN'S WOOD ANNUAL PACK

The Children's Wood Annual Pack contains a year's worth of outdoor activities for schools, teachers and parents to use with children. A major motivation for the creation of this pack is to help inspire teachers and classes to get out into natural environments and learn outdoors. Although (of course) we would encourage you to come along and try out these activities at the meadow and Children's Wood, the activities have been designed to be used in any suitable outdoor space.



MONTH	CURRICULUM LINK	CfE AREA	Activity LEVEL
AUGUST	Eco Drama	Science / Literacy	First
SEPTEMBER	Sukkot	RME	Second
	Planting	Science- Biodiversity	Early
OCTOBER	Halloween	Literacy	First
NOVEMBER	St Andrew's	RME/Literacy	Second
	Christmas	Science - Planet Earth/Technology- Craft	First
DECEMBER	Winter	Literacy/Technology - ICT	Early
	Burns Supper	Literacy	First
JANUARY	Space Project	Science - Space	Second
	When Gran was a Girl	Social - People, Past and Societies	First
FEBRUARY	Earth Day	Science - Planet Earth	Second
APRIL	Elf, Pixie and Fairy Festival	Expressive Arts	Early

The table above details the activities that are included in this pack. Some of these activities link to seasonal events organised at the Children's Wood and North Kelvin Meadow throughout the year. We hope that you will find our suggested activities useful and that they will fit in with the topics you are already doing in school.

This Annual Pack has been produced by teachers, is clearly linked to Curriculum for Excellence experiences and outcomes, and includes a range of activities across Early, First and Second Levels. The activities cover a number of curricular areas including Science, Literacy, RME and Expressive Arts.

Please be aware that this is a public space and you may meet other schools and members of the community whilst visiting. We would greatly appreciate you leaving the land as you find it (or better)!

To find out more about The Children's Wood Education Pack, email:- childrenswodeducation@gmail.com



SEPTEMBER

ACTIVITY

The SUKKOT - Festival of Booths

OUTLINE

Read the story of the Sukkot.

Take the children outside to a wild/wood space.

Explain that the children will be using the story to create their own Booth or tabernacle using loose materials from the ground or rope and tarpaulin.

Explain all the safety requirements needed to transport equipment and rules of communication to keep everyone safe.

Allow enough time for children to create a den or Booth but also additional time for the children to decorate it using natural materials.

Follow the special rules for constructing the roof.

Decorate with lots of natural details and 4 different plants in the Sukkot.

Once the children have created the Booth it is important that they have time to play and have quiet time.

Take the children's packed lunches so that they can eat and socialise in their own Booths.



RESOURCES

A copy of the story/Packed lunches/ Loose materials- branches, leaves/Open space

LINKS TO THE CURRICULUM FOR EXCELLENCE

I have explored some beliefs of the Jewish and/or Muslim communities. **RERC 2-25a**
I can identify some of the principles by which people of the Jewish and/or Muslim faith communities live. **RERC 2-26a**

ADDITIONAL RESOURCES TO ACCOMPANY ACTIVITIES

WHEN GRAN WAS A GIRL



ADDITIONAL RESOURCES TO ACCOMPANY ACTIVITIES

WHEN GRAN WAS A GIRL





PLANNING DECISION NOTICE

Full Planning Permission GRANTED SUBJECT TO CONDITION(S)

IN RESPECT OF APPLICATION 15/01223/DC

Use of site as community woodland and park (sui generis).

AT

Site At Kelbourne Street/Sanda Street/ Clouston Street Glasgow

AS SHOWN ON THE FOLLOWING APPROVED PLAN(S) AND IN CONDITION 01

'Unnumbered location plan drawing' received and stamped by DRS on 21 May 2015
Drawing 1 'Plan of Site Both Existing and Proposed'

This consent is granted subject to the following condition(s) and reason(s):

01. The development shall be implemented in accordance with drawing number(s)

'Unnumbered location plan drawing' received and stamped by DRS on 21 May 2015
Drawing 1 'Plan of Site Both Existing and Proposed'

as qualified by the undernoted condition(s), or as otherwise agreed in writing with the Planning Authority.

Reason: As these drawings constitute the approved development.

02. Before any works on the site are begun, a scheme of landscaping for the site shall be submitted to and approved in writing by the planning authority. The scheme shall include details of hard and soft landscaping works including new planting, and any proposed new pathways within the site.

Reason: To ensure that the landscaping of the site contributes to the landscape quality and biodiversity of the area.

THIS IS AN IMPORTANT LEGAL DOCUMENT AND SHOULD BE KEPT SECURE FOR FUTURE REFERENCE

APPENDIX 7

SHED PLAN



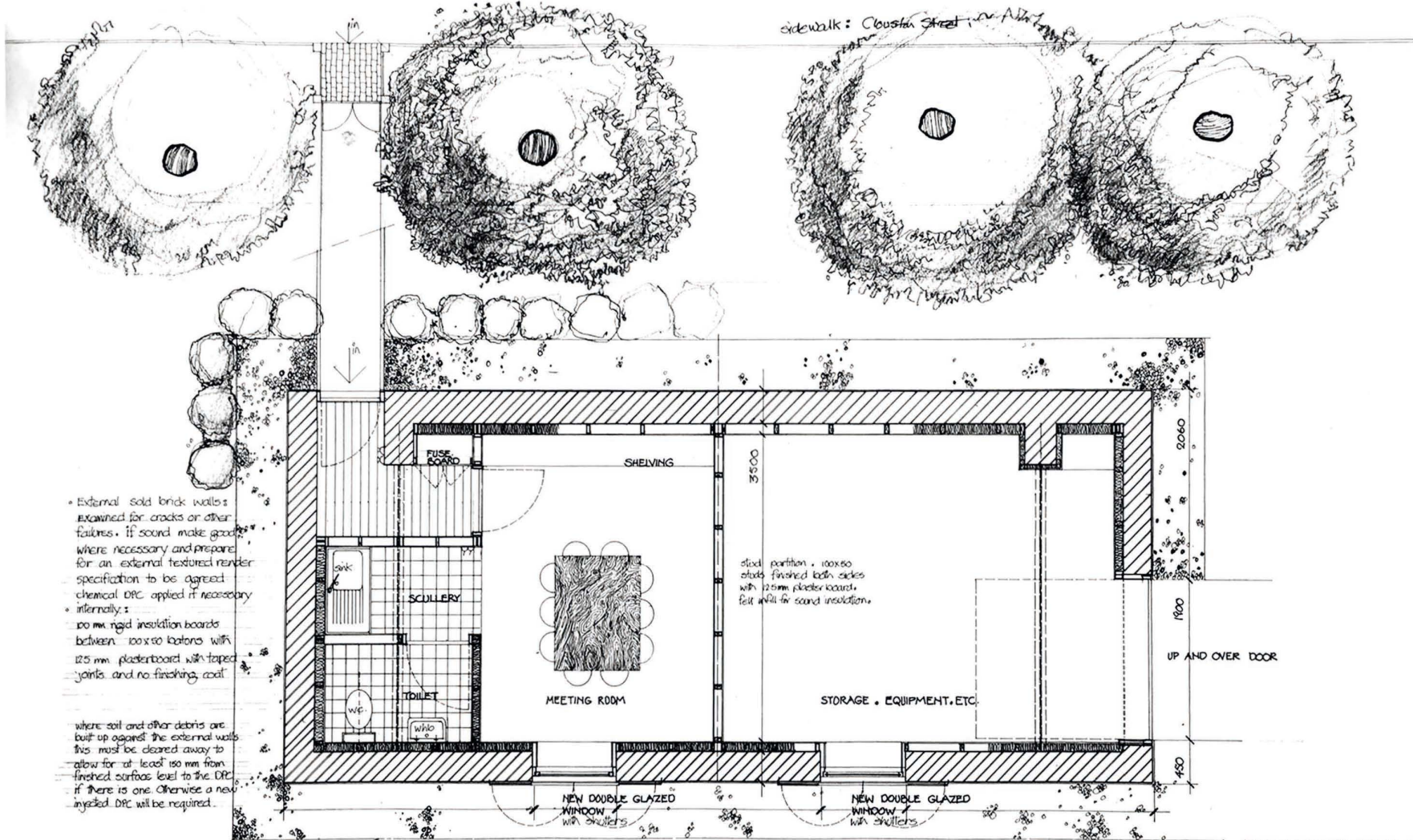

- External solid brick walls examined for cracks or other failures. If sound make good where necessary and prepare for an external textured render specification to be agreed. chemical DPC applied if necessary
 - Internally:
 - 100 mm rigid insulation boards between 100x80 batons with 12.5 mm plasterboard with taped joints and no finishing coat
- where soil and other debris are built up against the external walls this must be cleared away to allow for at least 150 mm from finished surface level to the DPC if there is one. Otherwise a new injected DPC will be required.

PLAN FOR PROPOSED DEVELOPMENT OF BRICK SHED INTO MEETING ROOM, TOILET AND STORAGE scale 1:250

ALEX MACGREGOR FRIAS, RIBA, MRCTP
 CHARTERED ARCHITECT
 108 ARKLESTON ROAD, PAISLEY, PA1 5TZ
 alex@cm.com

